

John Sutherland Esq
Down Clerk
Dornoch.

SUTHERLAND ESTATES OFFICE,

GOLSPIE.

June 20/35.

TELEPHONE NO 14.

Dear Sir,

In reply to yours of yesterday -
the piece of ground you refer to was leased
in 1849 to John Matheson, and in 1933
was assigned to John Grant, Butcher, Dornoch,
by the heir of the late W^o James Gunn.
It measures 45 feet along North & South sides
and 100 feet along East & West sides.

The original description was "Lot of
building ground on the Links of Dornoch
at the North side of the Lot or Down
of Sandycroft occupied by John Matheson"
No other boundaries are given.

Yours faithfully
Hoghill
Clerk

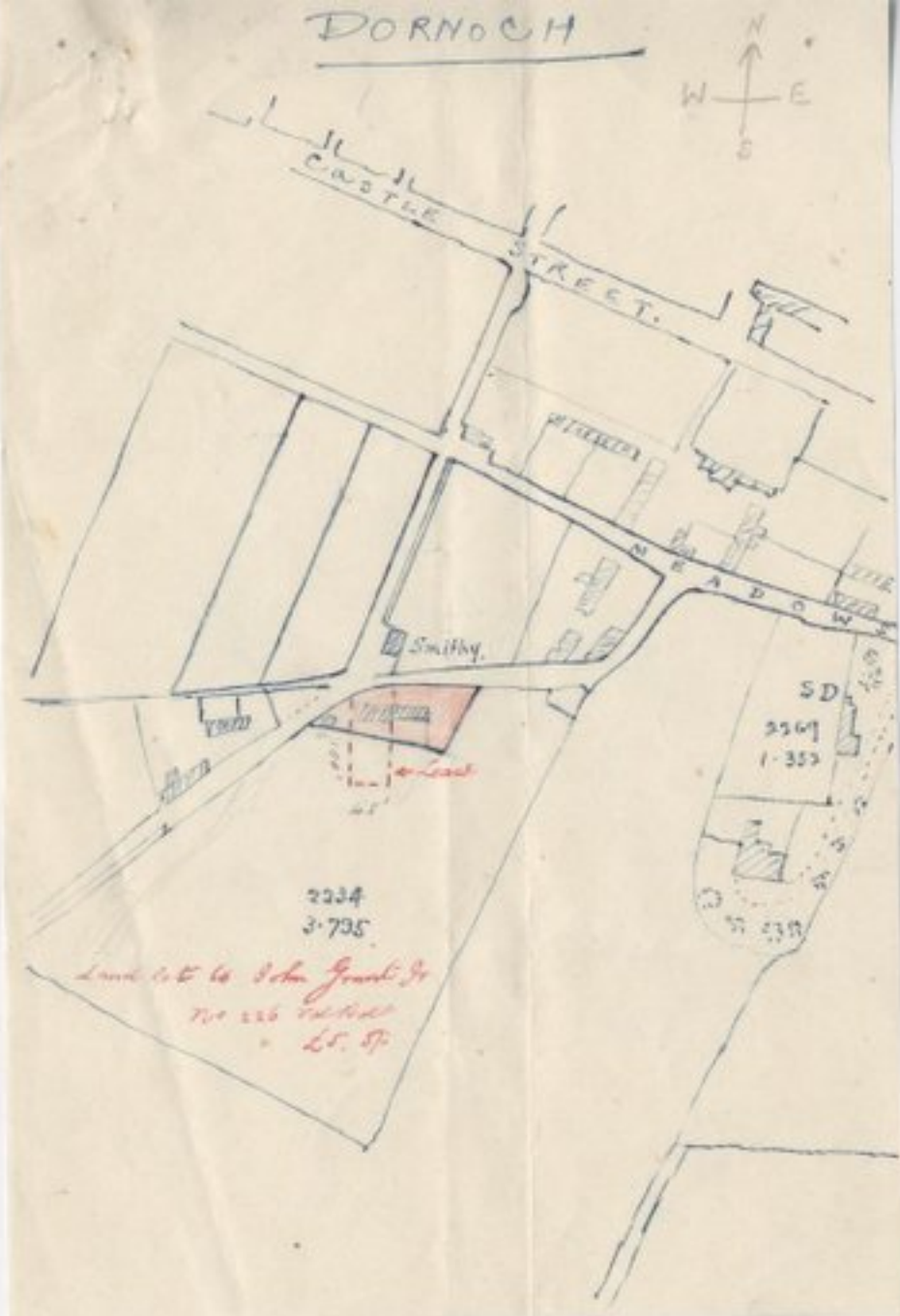

MUNRO & GRANT,
WHOLESALE AND RETAIL
BUTCHERS, POULTERERS AND
GAME DEALERS.

REGISTERED DAIRYMEN.

First quality Milk and Cream from our own
and Cows. Special Quotations submitted
for Milk Orders.

Received
29-7-35

Castle Street,

Dornoch, 25/7

5
193

(Sutherland).

J. Sutherland, Esq.
Town Clerk, ~~Golspie~~
Dornoch

Dear Sir, We have been seeing
Messrs. A. N. Macaulay Esq. Golspie.
regarding the fees of our property
at Sanderfoot with reference to
the proposed addition thereto.
We enclose a letter we have
received from Messrs. Macaulay
along with a copy of the Deed.
Apparently the original is in the
possession of Mr. H. F. Campbell, and
it will doubtless be impossible to
obtain this original until Mr. Campbell
returns to Dornoch. Perhaps the
copy will serve for the requirements
of the Deans of Guild Court.

Yours faithfully,

J. Grant

Enclosed.

of ten pounds Sterling shall not be built on the said lot
of ground hereby let within the space of ten years from the
first date of these presents and that the said house shall
be kept in good tenantable and sufficient repair, and that



JOHN SUTHERLAND,
TOWN CLERK.
TELEPHONE NO 5.

Town Clerk's Office,
Dornoch 2nd August 1935.

Chas. Grant Esq.,
Dean of Guild,
Sunnyside,
Dornoch.

Dear Sir,

Proposed additions to house
at Sandycroft, Dornoch

I have made various enquiries in regard to the boundaries of the above subjects as instructed by your Court and now enclose the following documents &c for your consideration, viz:-

1. Petition by Mr J. A. Grant.
2. Plan of proposed additions
3. Letter from Sutherland Estates Office dated 20th June last
4. Letter from Mr J.A.Grant dated 27th July last
5. Do. Sutherland Estates to Mr Grant dated 23rd July last.
6. Copy Tack between the Duke of Sutherland and the late Mr John Matheson.

You will observe from the Tack that the measurement of the boundaries are quite clear but the location of the ground is rather obscure as no adequate description of the adjoining property is given. In the circumstances the only point I would draw your attention to is the possible encroachment on the roadway behind the house.

Yours faithfully,

Sutherland