



Highland Archaeology Services Ltd

Bringing the past and future together

Archaeological Recording



The Bungalow, Culrain
Sutherland

Archaeological Recording

The Bungalow, Culrain Sutherland

Report No.	HAS060709
Client	S Bayliss
Planning Ref	05/00324/FULSU
Date	28 July 2006
Author	John Wood

Contents

Acknowledgements	3
Summary.....	3
List of Figures.....	4
Introduction	5
Aims and Objectives.....	5
Site details and archaeological background.....	5
Location.....	6
The Archaeology programme	7
<i>Desk Based Assessment</i>	7
<i>Initial pre-alteration photographic record</i>	9
<i>Trial trenching</i>	14
Trench 1	15
Trench 2	15
Trench 3	15
Trench 4	15
Trench 5	15
Results and Recommendations	19
Appendix 1: Levels.....	20
Appendix 2: Site Photographs	21
Appendix 3: Finds Photographs.....	24
Appendix 4: Highland Council Archaeological Brief.....	27

CDROM contains all photographs, digital mapping, and a copy of this report in PDF format

Acknowledgements

Mary Peteranna carried out the majority of the fieldwork and cleaned and photographed the finds. The assistance of Vincent O'Hare is also greatly appreciated. Thanks are also due to Dave Hodgson of Highland Council's Archaeology Unit for helpful discussion.

Summary

A programme of archaeological recording was carried at The Bungalow, Culrain, Sutherland in April 2006, prior to demolition and replacement of the existing house. The bungalow was photographed, and trial trenches were excavated to uncover a sample of the site, as required by the Planning Authority. No archaeological features or finds were recorded during these excavations. There are no proposals for any follow-up work in this case.

List of Figures

Figure 1 Site Location	6
Figure 2 Extract from 1st edition OS 1:10560 map (1881)	7
Figure 3 Extract from OS 1:2500 map (1967)	8
Figure 4 Current Ordnance Survey 1:2500 mapping	8
Figure 5 The Bungalow – sketch plan (as existing). Not to scale	9
Figure 6 The Bungalow from the NW showing rear extension	10
Figure 7 The Bungalow from the South, showing front extension	10
Figure 8 Kitchen and cupboards	11
Figure 9 Sitting Room	11
Figure 10 Hallway and door to bathroom	12
Figure 11 Bedroom 2	12
Figure 12 Bedroom 1	13
Figure 13 Sheds to North of The Bungalow	13
Figure 14 Trenches as excavated	14
Figure 15 Soakaway	14
Figure 16 Trench 1, looking west	16
Figure 17 Trench 2 looking north	16
Figure 18 Drain to soakaway, encountered in Trench 1	17
Figure 19 Trench 3, looking north	17
Figure 20 Trench 4, looking west	18
Figure 21 Trench 5, looking west	18
Figure 22 Finds were all apparently 20th c. in date	19
Figure 23 Levels	20
Figure 24 Camera points	23

Introduction

A programme of archaeological recording and pre-determination evaluation was carried out in April 2006 by Highland Archaeology Services Ltd on behalf of Mr S Bayliss to fulfil an archaeological planning condition at The Bungalow, Culrain, Sutherland. The proposed development required the demolition of the existing house and the erection of an extension to the rear. (Planning Application no. 05/00324/FULSU)

The archaeological programme was designed to provide mitigation and recording in line with the Highland Council's Structure Plan policies, and the Scottish Executive's National Planning Policy Guidance Note 5 (NPPG5) and Planning Advice Note 42 (PAN42) (SOEND 1994).

The purpose of the work was to identify and record the nature and extent of any archaeological features revealed or affected by the intended development. This report summarises the results. The principle of preservation in situ was adhered to.

Aims and Objectives

The purpose of the archaeology programme was to:

1. Minimise any possible delay or cost to the development by anticipating archaeological requirements as far as possible, timetabling and integrating archaeological recording work with the project, and dealing with any issues arising quickly and efficiently.
2. Determine as far as possible the character, extent, condition, date and significance of any archaeologically significant remains; and to preserve these where possible and record where necessary in line with NPPG 5 (SOEND 1994) and PAN 42 (SOEND 1994).
3. Meet the archaeological requirements of the Highland Council for this project

Site details and archaeological background

The Bungalow, Culrain is a mid-20th century single storey house. There are no archaeological sites or features recorded within the development area, but an archaeological investigation was requested in this case because the site lies in the vicinity of the site of the Battle of Carbisdale. This was the last battle of the Marquis of Montrose in April 1650. Although it is believed to have its centre at OS grid reference NH 563 958, it could extend over a wide area. Unfortunately, battle sites can be difficult to assess archaeologically as there is often very little to find. Another archaeological evaluation, including trial trenching and geophysics at Rosebank, Culrain in early 2006 produced no features that could be associated with the battle.

The proposed development would require the excavation of a site for the house itself, as well as a drive, drains and services. Trial trenches were therefore proposed to determine the presence/absence, nature, depth, extent and importance of any remains present within these areas. Areas that would be undisturbed by the development were not assessed.

Location

The cottage is centred approximately at Ordnance Survey National Grid Reference NH574 947.

It is within the local authority area of the Highland Council, which is advised on archaeological matters by its Archaeology Unit staff based within the Council's Planning and Development Service (HCAU).

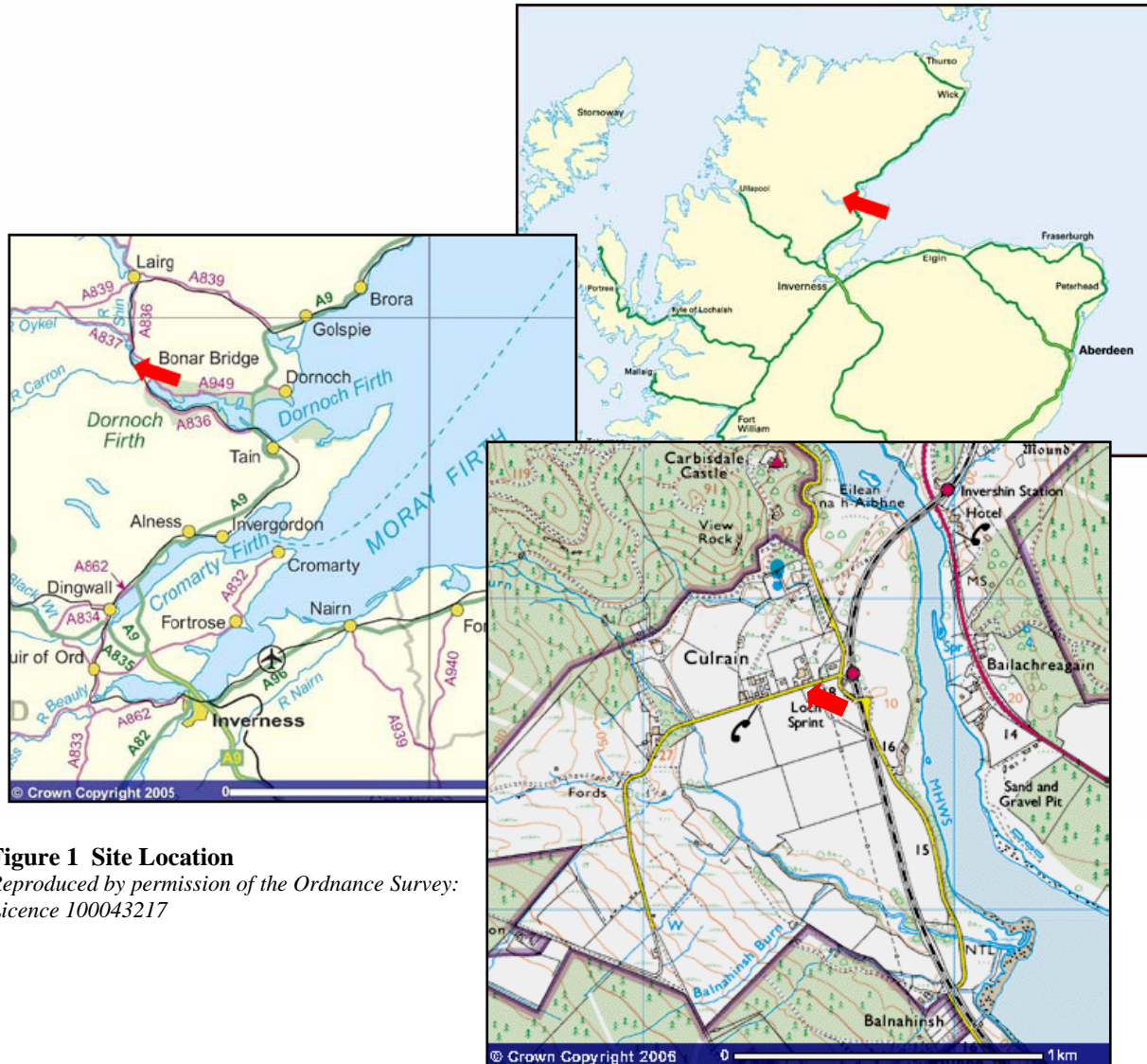

Figure 1 Site Location

*Reproduced by permission of the Ordnance Survey:
Licence 100043217*

The Archaeology programme

Desk Based Assessment

The Highland Council Sites and Monuments Record (SMR) and the National Monuments Record for Scotland as well as the Historic Scotland Listed Building details were checked online, as were the map collections of the national Library of Scotland. The Highland Council's SMR and archives were then visited and checked in more detail. Historic Ordnance Survey and other mapping, and relevant aerial photographs were checked online and at the Highland Council's offices.

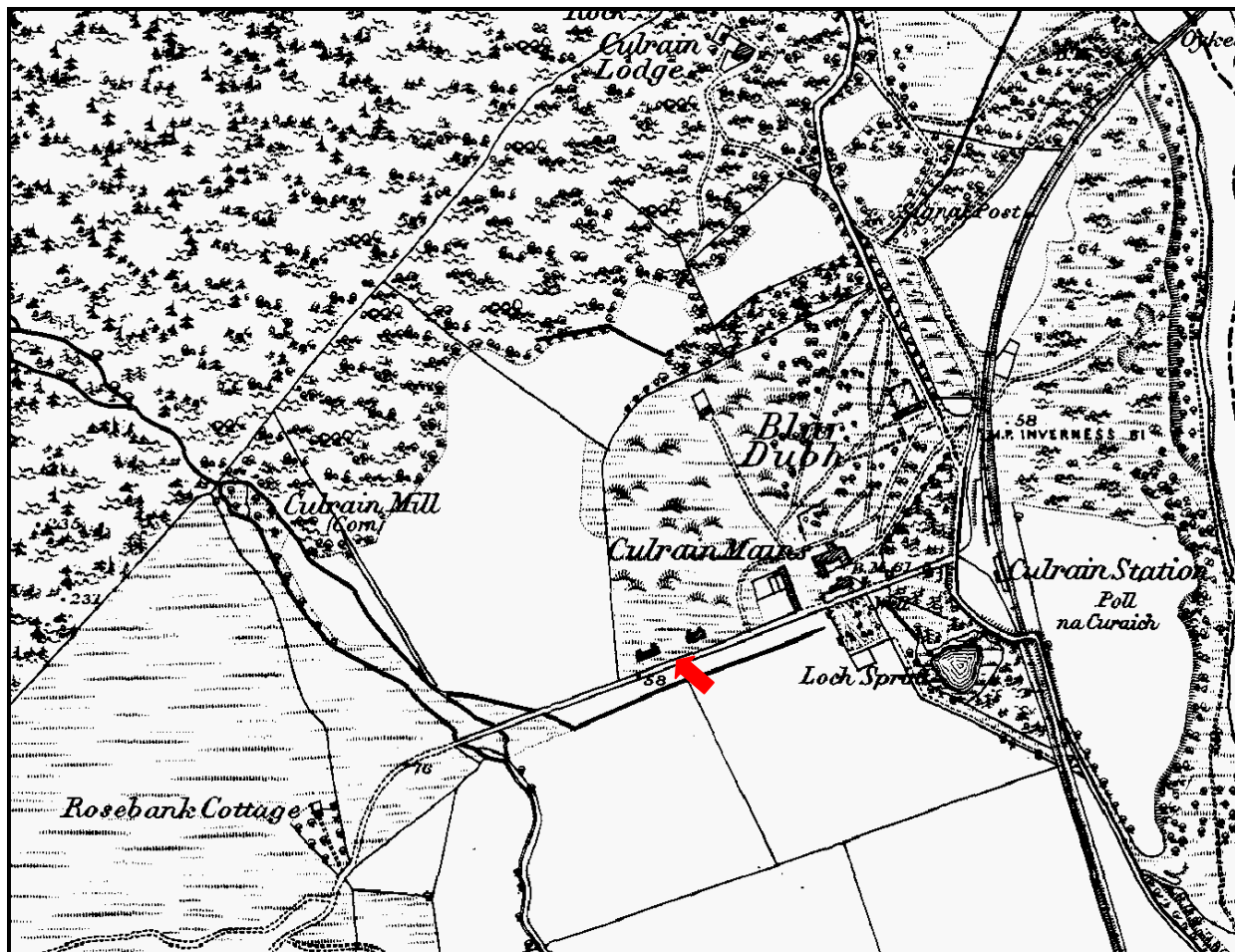

Figure 2 Extract from 1st edition OS 1:10560 map (1881)
(Not to scale)



Figure 3 Extract from OS 1:2500 map (1967)
 Courtesy of Landmark Information Group(Not to scale)

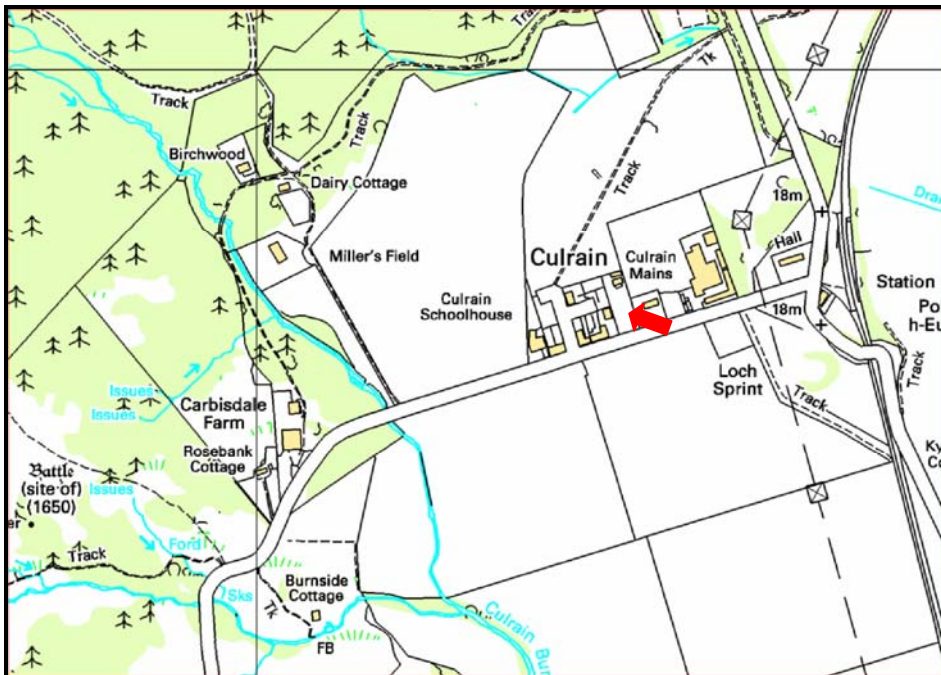

Figure 4 Current Ordnance Survey 1:2500 mapping
 Reproduced by permission of the Ordnance Survey: Licence 100043217 (Not to scale)

Initial pre-alteration photographic record

A digital photographic record was completed on 30 March 2006. A selection of photographs appears as figs ***. A full set is included on the accompanying CDROM. The sketch plan (Fig 8) is indicative only and does not accurately represent the dimensions or proportions of the rooms.

The Bungalow as a whole appears to be mid-late 20th century in date and constructed of brick and concrete with a corrugated iron roof to the main house, and felted flat roofs to the two later extensions. There are no indications of it having been adapted from an older cottage, and no building is shown on this site on the 1st edition Ordnance Survey 6 inch map (1881) (Fig 2). The current Ordnance Survey plan does not show the rear extension forming bedroom 1 or the porch / bathroom extension on the front of the house (See Figs 6 and 7). It is not known when these were added, but they are probably post-1967.

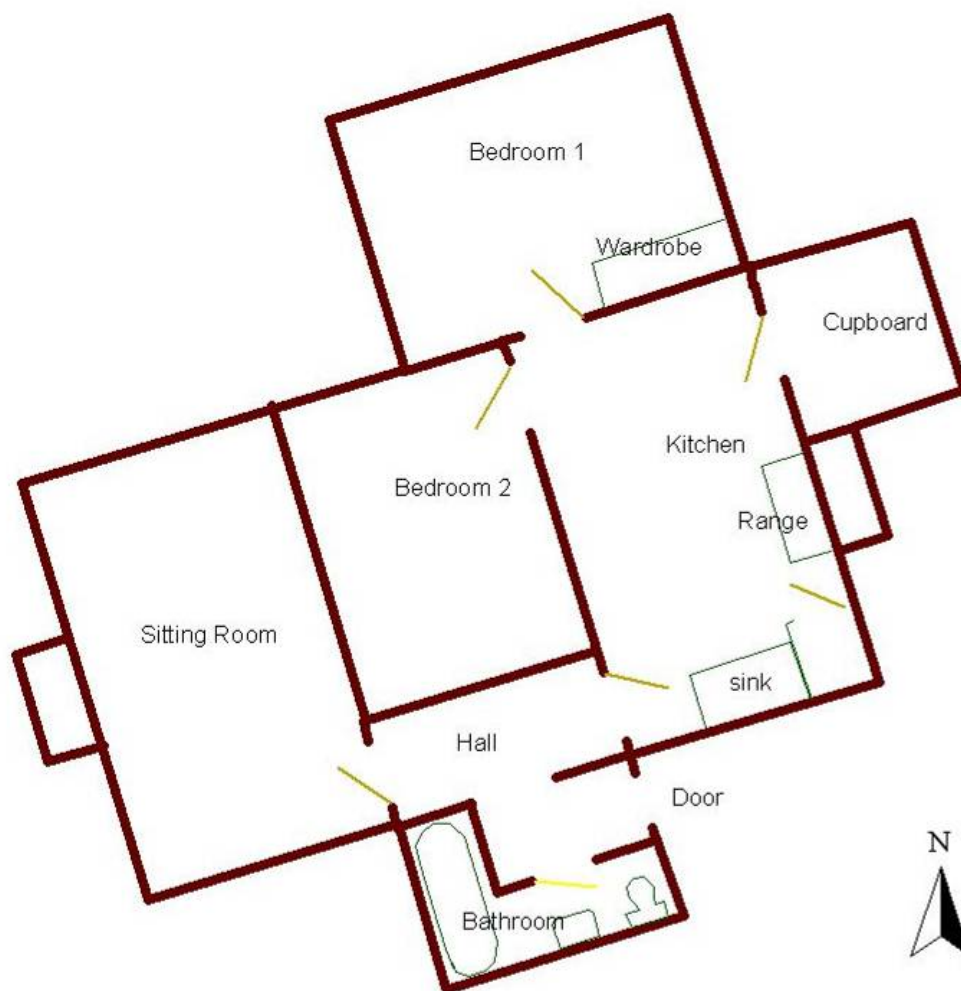

Figure 5 The bungalow – sketch plan (as existing). Not to scale.



Figure 6 The Bungalow from the NW showing rear extension



Figure 7 The Bungalow from the South, showing front extension



Figure 8 Kitchen and cupboards



Figure 9 Sitting Room



Figure 10 Hallway and door to bathroom



Figure 11 Bedroom 2



Figure 12 Bedroom 1



Figure 13 Sheds to North of The Bungalow

Trial trenching

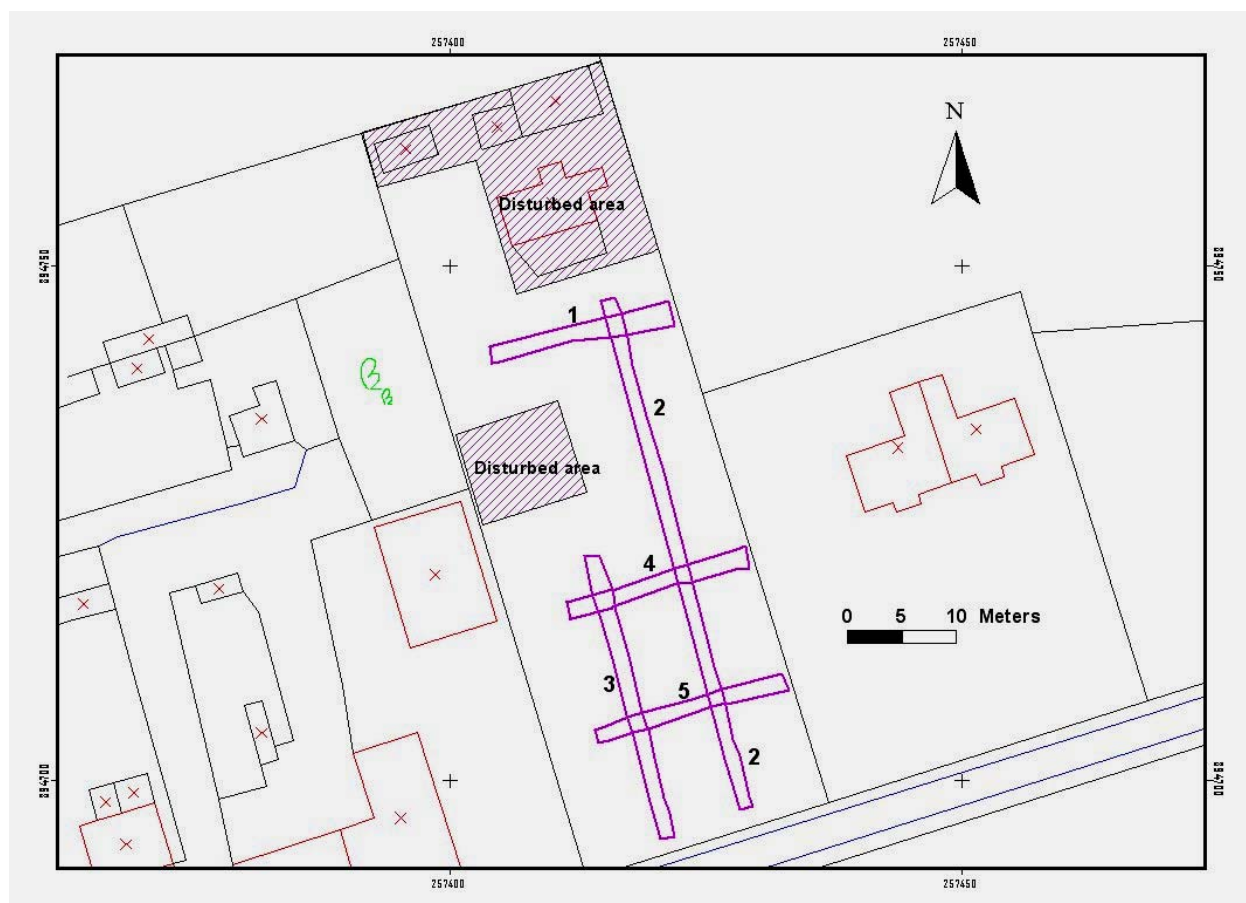

Figure 14 Trenches as excavated
Note Trench numbers.



Figure 15 Soakaway

All trenches were cut with a 1.5m wide ditching bucket on a back-acting mechanical excavator, under the supervision of an archaeologist. Where necessary hand cleaning by hoe and / or trowel was then undertaken to check any possible features. Two parts of the site could not be excavated – the ground occupied by the existing house and sheds, and the cess pit / soakaway. These are marked as *Disturbed Areas* on Figure 14.

Trench 1

This was an additional trench cut to check the northern area of the site. It was approximately 18.2m long, running roughly east-west across the site. The depth varied but averaged about 500mm. This trench encountered the drain from the bungalow to the soakaway at approximate grid ref 257409 894743. See Figs 16 and 18

Trench 2

This was approximately 51.2m long, running roughly north-south across the site, parallel to Trench 1. The depth varied but averaged about 500mm. See Fig 17. A grown-over section of metalling for the driveway was encountered in this trench at approximate grid ref 257422 894712

Trench 3

This was approximately 28.5m long, running roughly north-south across the site. The depth varied but averaged about 500mm. See Fig 19.

Trench 4

This was approximately 18.4m long, running roughly east-west across the site. The depth varied but averaged about 500mm. The ground rose sharply at the western end of this trench where it had been made up to form a platform for the adjoining property. See Fig 20.

Trench 5

This was approximately 19m long, running roughly east-west across the site. The depth varied but averaged about 500mm. The ground rose sharply at the western end of this trench where it had been made up to form a platform for the adjoining property. See Fig 21.



Figure 16 Trench 1, looking west



Figure 17 Trench 2 looking north



Figure 18 Drain to soakaway, encountered in Trench
1



Figure 19 Trench 3, looking north



Figure 20 Trench 4, looking west



Figure 21 Trench 5, looking west

Results and Recommendations

The Bungalow, Culrain, appears to have been built in the mid 20th century on a previously unoccupied site. There has been considerable disturbance however over much of the site, with the creation of a rough driveway, dumping of material, the excavation of a soakaway, and the western site edge built up to form a platform for the adjoining house.

No evidence of activity was found associated with the Battle of Carbisdale or indeed otherwise, other than by the 20th century occupants of The Bungalow . There are no recommendations for further archaeological work in this case.

All finds were apparently of 20th century date. The area had apparently been much disturbed by the creation of a soakaway and the dumping of materials at various dates, but there was no apparent residual material from earlier occupation.



Figure 22 Finds were all apparently 20th c. in date

Appendix 1: Levels

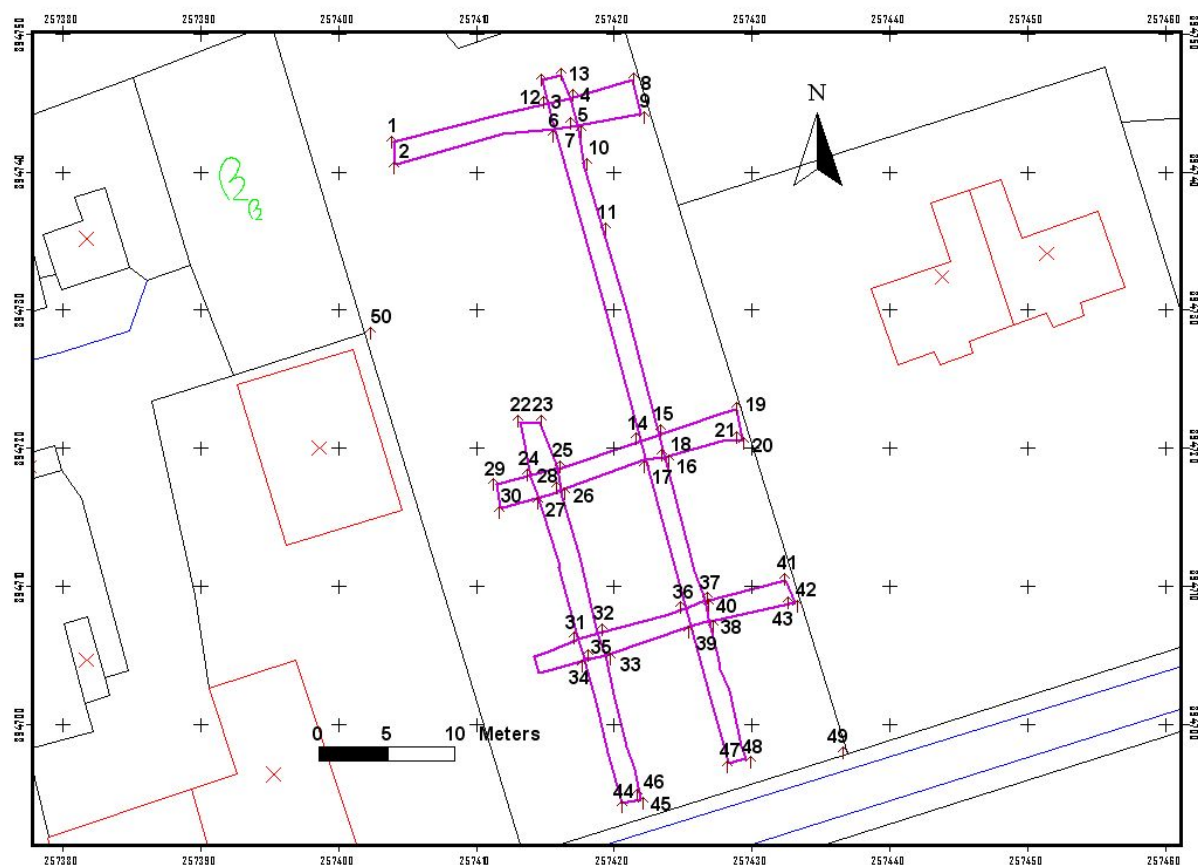

Figure 23 Levels

Level No.	Height OD	Level No.	Height OD	Level No.	Height OD
1	17.631	18	16.326	35	16.175
2	17.590	19	16.739	36	16.617
3	17.202	20	16.642	37	16.728
4	16.801	21	16.511	38	16.769
5	16.591	22	16.386	39	16.688
6	16.846	23	16.251	40	16.460
7	16.350	24	15.981	41	17.192
8	16.598	25	16.127	42	17.122
9	16.675	26	16.084	43	16.609
10	16.003	27	15.940	44	16.795
11	15.862	28	15.904	45	16.763
12	17.345	29	16.679	46	16.406
13	17.156	30	16.475	47	16.762
14	16.549	31	16.285	48	16.765
15	16.539	32	16.480	49	17.081
16	16.476	33	16.464	50	17.642
17	16.593	34	16.446		

Appendix 2: Site Photographs

All photography was digital and digital copies (JPEGs) of all photographs are included on the CDROM accompanying this report together with versions of the mapping data used in the report (DXF or ArcView Shapefile formats). The camera location of each site photograph taken is shown in Fig 24 below.

Photo No.	Camera Location	Notes	Taken by	Date
			JW	30/03/2006
IMGP5625	CP1	View N across site	JW	30/03/2006
IMGP5626	CP2	View N across site to Bungalow	JW	30/03/2006
IMGP5627	CP3	View NNW across site to Bungalow	JW	30/03/2006
IMGP5628	CP4	View SE across site	JW	30/03/2006
IMGP5629	CP4	View NE across site	JW	30/03/2006
IMGP5630	CP4	View E across site	JW	30/03/2006
IMGP5631	CP5	View S along E boundary of site	JW	30/03/2006
IMGP5632	CP6	View SW - The Bungalow	JW	30/03/2006
IMGP5633	CP6	View N - Sheds to rear of bungalow	JW	30/03/2006
IMGP5634	CP6	View NW - Sheds to rear of bungalow	JW	30/03/2006
IMGP5635	CP6	View W - The Bungalow	JW	30/03/2006
IMGP5636	CP7 (approx)	Eastern shed - interior	JW	30/03/2006
IMGP5637	CP7 (approx)	Eastern shed - interior	JW	30/03/2006
IMGP5638	CP7 (approx)	Eastern shed - interior	JW	30/03/2006
IMGP5639	CP8	View W - Sheds to rear of bungalow	JW	30/03/2006
IMGP5640	CP8	View N - eastern shed - interior	JW	30/03/2006
IMGP5641	CP9	View NE - The Bungalow (kitchen window)	JW	30/03/2006
IMGP5642	CP9	View N - The Bungalow (bathroom window)	JW	30/03/2006
IMGP5643	CP9	View NNE - The Bungalow	JW	30/03/2006
IMGP5644	CP9 (approx)	View NNW - The Bungalow	JW	30/03/2006
IMGP5645	CP9 (approx)	View NE - The Bungalow (close-up, bathroom extension)	JW	30/03/2006
IMGP5646	Internal	The Bungalow - Kitchen	JW	30/03/2006
IMGP5647	CP10	View NE - Sheds to rear of bungalow	JW	30/03/2006
IMGP5648	CP10	View N - collapsed shed	JW	30/03/2006
IMGP5649	CP10	View NW - W shed to rear of bungalow	JW	30/03/2006
IMGP5650	CP11	View SE - The Bungalow	JW	30/03/2006
IMGP5651	CP11	View E - collapsed shed	JW	30/03/2006

Photo No.	Camera Location	Notes	Taken by	Date
IMGP5652	CP12	View W across site	JW	30/03/2006
IMGP5653	Internal	The Bungalow - Kitchen	JW	30/03/2006
IMGP5654	Internal	The Bungalow - Kitchen	JW	30/03/2006
IMGP5655	Internal	The Bungalow - Kitchen	JW	30/03/2006
IMGP5656	Internal	The Bungalow - Kitchen	JW	30/03/2006
IMGP5657	Internal	The Bungalow - Kitchen	JW	30/03/2006
IMGP5658	Internal	The Bungalow - Bedroom 2	JW	30/03/2006
IMGP5659	Internal	The Bungalow - Bedroom 2	JW	30/03/2006
IMGP5660	Internal	The Bungalow - Bedroom 2	JW	30/03/2006
IMGP5661	Internal	The Bungalow - Bedroom 2	JW	30/03/2006
IMGP5662	Internal	The Bungalow - Bedroom 1	JW	30/03/2006
IMGP5663	Internal	The Bungalow - Bedroom 1	JW	30/03/2006
IMGP5664	Internal	The Bungalow - Bedroom 1	JW	30/03/2006
IMGP5665	Internal	The Bungalow - Bedroom 1	JW	30/03/2006
IMGP5666	Internal	The Bungalow - Hall and Bathroom	JW	30/03/2006
IMGP5667	Internal	The Bungalow - Bathroom	JW	30/03/2006
IMGP5668	Internal	The Bungalow - Bathroom	JW	30/03/2006
IMGP5669	Internal	The Bungalow - Sitting Room	JW	30/03/2006
IMGP5670	Internal	The Bungalow - Sitting Room	JW	30/03/2006
IMGP5671	Internal	The Bungalow - Sitting Room	JW	30/03/2006
IMGP5672	Internal	The Bungalow - Sitting Room	JW	30/03/2006
IMGP5673	Internal	The Bungalow - Sitting Room	JW	30/03/2006
IMGP5674	Internal	The Bungalow - Sitting Room, looking through hallway to kitchen	JW	30/03/2006
IMGP5675	Internal	The Bungalow - Sitting Room, looking through hallway to kitchen	JW	30/03/2006
IMGP5676	Internal	The Bungalow - Hall and Bathroom	JW	30/03/2006
IMGP5677	Internal	The Bungalow - Hall from Kitchen doorway	JW	30/03/2006
IMGP5678	Internal	The Bungalow - Kitchen	JW	30/03/2006
IMGP5679	Internal	The Bungalow - Kitchen	JW	30/03/2006
IMGP5680	Internal	The Bungalow - Kitchen, looking through to Bedroom 2	JW	30/03/2006
IMGP5682	CP2	View N	JW	30/03/2006
IMGP5683	CP13	View NW	JW	30/03/2006
IMGP5684	CP13	View N	JW	30/03/2006
IMGP5691	CP14	Trench 2 view N	JW	10/04/2006
IMGP5692	CP15	Trench 2 view N	JW	10/04/2006
IMGP5693	CP15	Trench 2 view S	JW	10/04/2006
IMGP5694	CP15	Trench 5 view W	JW	10/04/2006
IMGP5695	CP15	Trench 5 view E	JW	10/04/2006
IMGP5696	CP16	Trench 2 view N	JW	10/04/2006
IMGP5697	CP16	Trench 2 view S	JW	10/04/2006
IMGP5698	CP16	Trench 4 view W	JW	10/04/2006
IMGP5699	CP16	Trench 4 view E	JW	10/04/2006
IMGP5700	CP17	Trench 2 view N	JW	10/04/2006
IMGP5701	CP17	Trench 2 view S	JW	10/04/2006
IMGP5702	CP17	Trench 1 view W	JW	10/04/2006

Photo No.	Camera Location	Notes	Taken by	Date
IMGP5703	CP17	Trench 1 view E	JW	10/04/2006
IMGP5704	CP18	Trench 2 view S	JW	10/04/2006
IMGP5705	CP19	Trench 1 view W	JW	10/04/2006
IMGP5706	CP20	Trench 1 - drain from house	JW	10/04/2006
IMGP5707	CP21	Trench 1 view E	JW	10/04/2006
IMGP5708	CP22	View N across soakaway	JW	10/04/2006
IMGP5709	CP23	Trench 3 view S	JW	10/04/2006
IMGP5710	CP24	Trench 3 view S	JW	10/04/2006
IMGP5711	CP24	Trench 4 view E	JW	10/04/2006
IMGP5712	CP24	Trench 4 view W	JW	10/04/2006
IMGP5713	CP25	Trench 3 view S	JW	10/04/2006
IMGP5714	CP25	Trench 3 view N	JW	10/04/2006
IMGP5715	CP25	Trench 5 view E	JW	10/04/2006
IMGP5716	CP25	Trench 5 view W	JW	10/04/2006
IMGP5717	CP26	Trench 3 view N	JW	10/04/2006
IMGP5718	CP27	Trench 5 view E	JW	10/04/2006
IMGP5719	CP28	Trench 4 view E	JW	10/04/2006
IMGP5720	CP29	Trench 4 view W	JW	10/04/2006
IMGP5721	CP30	Trench 5 view W	JW	10/04/2006

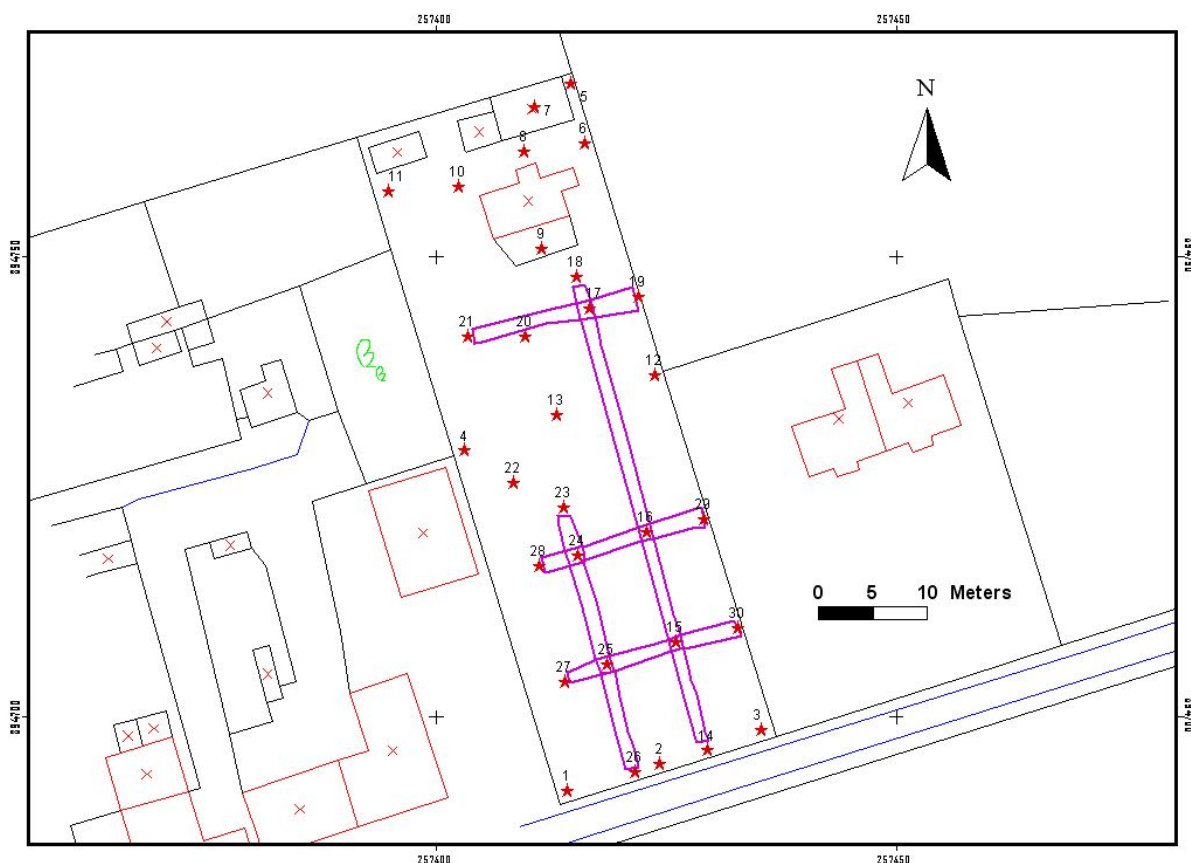

Figure 24 Camera points

Appendix 3: Finds Photographs

Photo No.	Trench	Bag	Notes	Photo Taken by	Date
1	1	1	Ceramics Wh SW/Pc	MKP	12/06/2006
2	1	1	Ceramics Wh SW/Pc	MKP	12/06/2006
3	1	1	Ceramics Wh SW/Pc	MKP	12/06/2006
4	1	1	Ceramics Wh SW/Pc	MKP	12/06/2006
5	1	1	Ceramics Wh SW/Pc	MKP	12/06/2006
6	1	1	Ceramics Wh SW/Pc	MKP	12/06/2006
7	1	2	Ceramics SW/Pc decorated	MKP	12/06/2006
8	1	2	Ceramics SW/Pc decorated	MKP	12/06/2006
9	1	2	Ceramics SW/Pc decorated	MKP	12/06/2006
10	1	2	Ceramics SW/Pc decorated	MKP	12/06/2006
11	1	2	Ceramics SW/Pc decorated	MKP	12/06/2006
12	1	2	Ceramics SW/Pc decorated	MKP	12/06/2006
13	1	2	Ceramics SW/Pc decorated	MKP	12/06/2006
14	1	2	Ceramics SW/Pc decorated	MKP	12/06/2006
15	1	3	Iron screw	MKP	12/06/2006
16	1	3	Iron screw	MKP	12/06/2006
17	1	4	Iron knife / handle	MKP	12/06/2006
18	1	4	Iron knife / handle	MKP	12/06/2006
19	2	5	Ceramics Wh SW jug frags	MKP	12/06/2006
20	2	5	Ceramics Wh SW jug frags	MKP	12/06/2006
21	2	6	Ceramics Wh SW	MKP	12/06/2006
22	2	6	Ceramics Wh SW	MKP	12/06/2006
23	2	7	Ceramics SW Bl/Wh decorated	MKP	12/06/2006
24	2	7	Ceramics SW Bl/Wh decorated	MKP	12/06/2006
25	2	8	Ceramics SW glazed frags	MKP	12/06/2006
26	2	8	Ceramics SW glazed frags	MKP	12/06/2006
27	2	9	Ceramics Wh SW w/writing	MKP	12/06/2006
28	2	9	Ceramics Wh SW w/writing	MKP	12/06/2006
29	2	10	Metal badge	MKP	12/06/2006
30	2	10	Metal badge	MKP	12/06/2006
31	2	11	Unknown tool handle - for welding	MKP	12/06/2006
32	2	11	Unknown tool handle - for welding	MKP	12/06/2006
33	2	11	Unknown tool handle - for welding	MKP	12/06/2006
34	3	12,13,14,15,16	Balnagowan Hotel, Ardgay SW jug frags	MKP	12/06/2006
35	3	12,13,14,15,16	Balnagowan Hotel, Ardgay SW jug frags	MKP	12/06/2006

Photo No.	Trench	Bag	Notes	Photo Taken by	Date
36	3	12,13,14,15,16	Balnagowan Hotel, Ardgay SW jug frags	MKP	12/06/2006
37	3	12,13,14,15,16	Balnagowan Hotel, Ardgay SW jug frags	MKP	12/06/2006
38	3	12,13,14,15,16	Balnagowan Hotel, Ardgay SW jug frags	MKP	12/06/2006
39	3	12,13,14,15,16	Balnagowan Hotel, Ardgay SW jug frags	MKP	12/06/2006
40	3	12,13,14,15,16	Balnagowan Hotel, Ardgay SW jug frags	MKP	12/06/2006
41	3	12,13,14,15,16	Balnagowan Hotel, Ardgay SW jug frags	MKP	12/06/2006
42	3	12,13,14,15,16	Balnagowan Hotel, Ardgay SW jug frags	MKP	12/06/2006
43	3	12,13,14,15,16	Balnagowan Hotel, Ardgay SW jug frags	MKP	12/06/2006
44	3	12,13,14,15,16	Balnagowan Hotel, Ardgay SW jug frags	MKP	12/06/2006
45	3	12,13,14,15,16	Balnagowan Hotel, Ardgay SW jug frags	MKP	12/06/2006
46	3	12,13,14,15,16	Balnagowan Hotel, Ardgay SW jug frags	MKP	12/06/2006
47	3	12,13,14,15,16	Balnagowan Hotel, Ardgay SW jug frags	MKP	12/06/2006
48	3	12,13,14,15,16	Balnagowan Hotel, Ardgay SW jug frags	MKP	12/06/2006
49	3	17	Ceramic SW jar - Plynine Co Ammonia	MKP	12/06/2006
50	3	17	Ceramic SW jar - Plynine Co Ammonia	MKP	12/06/2006
51	3	17	Ceramic SW jar - Plynine Co Ammonia	MKP	12/06/2006
52	3	18	Ceramic jar SW Wh	MKP	12/06/2006
53	3	18	Ceramic jar SW Wh	MKP	12/06/2006
54	3	19	Ceramic SW jar - W.G.Nixey	MKP	12/06/2006
55	3	19	Ceramic SW jar - W.G.Nixey	MKP	12/06/2006
56	3	20	Glass bottle - Goodall Backhouse & Co - Yorkshire Relish	MKP	12/06/2006
57	3	20	Glass bottle - Goodall Backhouse & Co - Yorkshire Relish	MKP	12/06/2006
58	3	21	Glass bottle - Mason's OK Sauce	MKP	12/06/2006
59	3	21	Glass bottle - Mason's OK Sauce	MKP	12/06/2006
60	3	22	Brick frags	MKP	12/06/2006
61	3	22	Brick frags	MKP	12/06/2006
62	3	23	Slate frags	MKP	12/06/2006
63	3	23	Slate frags	MKP	12/06/2006
64	3	24	Iron nails	MKP	12/06/2006

Photo No.	Trench	Bag	Notes	Photo Taken by	Date
65	3	25	Animal bone - sheep or cow	MKP	12/06/2006
66	3	25	Animal bone - sheep or cow	MKP	12/06/2006
67	3	26	Ceramics - EW w/ cream glaze	MKP	12/06/2006
68	3	26	Ceramics - EW w/ cream glaze	MKP	12/06/2006
69	3	27	Ceramics - SW decorated Bl plate frags	MKP	12/06/2006
70	3	27	Ceramics - SW decorated Bl plate frags	MKP	12/06/2006
71	3	28	Ceramics - SW decorated	MKP	12/06/2006
72	3	28	Ceramics - SW decorated	MKP	12/06/2006
73	3	29	Coke or coal	MKP	12/06/2006
74	3	30	Ceramics - SW jug frags	MKP	12/06/2006
75	3	30	Ceramics - SW jug frags	MKP	12/06/2006
76	3	31	Iron frag	MKP	12/06/2006
77	3	31	Iron frag	MKP	12/06/2006
78	3	32	Glass frags	MKP	12/06/2006
79	3	33	Ceramics - Pc/SW w/ gold décor	MKP	12/06/2006
80	3	33	Ceramics - Pc/SW w/ gold décor	MKP	12/06/2006
81	3	34	Ceramics - SW Wh frags	MKP	12/06/2006
82	3	34	Ceramics - SW Wh frags	MKP	12/06/2006
83	3	34	Ceramics - SW Wh frags	MKP	12/06/2006
84	3	34	Ceramics - SW Wh frags	MKP	12/06/2006
85	3	35	Ceramics - SW/Pc with frags	MKP	12/06/2006
86	3	35	Ceramics - SW/Pc with frags	MKP	12/06/2006
87	4	36	Iron frags	MKP	12/06/2006
88	4	36	Iron frags	MKP	12/06/2006
89	4	37	Glass medicine bottle top	MKP	12/06/2006
90	4	38	Ceramics Wh décor frags	MKP	12/06/2006
91	4	38	Ceramics Wh décor frags	MKP	12/06/2006
92	4	39	Ceramics - SW Wh frags	MKP	12/06/2006
93	4	39	Ceramics - SW Wh frags	MKP	12/06/2006
94	4	40	Glass frags - gr	MKP	12/06/2006
95	5	41	Ceramics - SW jar frags	MKP	12/06/2006
96	5	41	Ceramics - SW jar frags	MKP	12/06/2006
97	5	42	Ceramics - decorated	MKP	12/06/2006
98	5	42	Ceramics - decorated	MKP	12/06/2006
99	5	43	Ceramics - braided decorated	MKP	12/06/2006
100	5	43	Ceramics - braided decorated	MKP	12/06/2006

Appendix 4: Highland Council Archaeological Brief



Brief for archaeological work at:

Culrain 05/00324/FULSU

PRE-DETERMINATION ARCHAEOLOGICAL EVALUATION

**HIGHLAND COUNCIL PLANNING AND DEVELOPMENT
SERVICE**

Archaeology Unit

1) Background

A planning application has been submitted for this site. A development of this type has the potential for direct adverse impacts on archaeological sites and on their setting. In line with government planning guidance (NPPG5) an archaeological evaluation requires to be conducted in order to allow an informed decision to be made on the likely impact of any proposals on the archaeological / historical heritage of the area.

In this case the nature and extent of any potential archaeological features needs to be established. An archaeological evaluation aims to identify any such features at the earliest possible stage - thus allowing 'preservation *in situ*' or 'preservation by record' of significant features, and minimising the risk of finds or features of interest inadvertently being discovered and damaged during site works. This approach is intended to ensure that any archaeology on site is identified and recorded with minimum delay or disruption to the development.

In this particular case, the application area lies in the vicinity of the site of the Battle of Carbisdale, which took place in 1650. The evaluation requires to determine the presence/absence, nature, depth extent and importance of any remains present.

To meet the needs of such an approach, the first requirement is for a desk based assessment to check available records. A geophysical survey and associated trial trenching programme will be undertaken to assess the presence of, and potential for, archaeological sites in the development area; to assess the significance of the sites that will be affected; and the impact of the proposed development upon them. Each assessment should be undertaken to a Written Scheme of Investigation (WSI), informed by, and referring to, this brief.

A report will be produced outlining the conclusions of this work and proposes appropriate mitigation and recording arrangements to be followed in the development scheme. Such arrangements might include redesign where practicable to avoid key areas, excavation and recording of features, and/or an archaeological watching brief on site clearance and excavations for construction purposes.

2) Terms of Reference

This brief specifies what is considered to be the **minimum** acceptable standard of work; proposals that present a higher standard may be offered and accepted. It is assumed that this will form the basis of an agreed approach unless changes are agreed with Highland Council Archaeology Unit in writing before the start of any site works.

This brief has been produced for the applicant, who will be responsible for the work, including any tendering and contractual arrangements. It sets out in detail who is responsible for what, as well as the terms of reference, objectives, method, monitoring and reporting arrangements.

The area to be covered by this assessment should be the entire development area: including any proposed services, access roads, works compounds, borrow pits or other ancillary works.

The work should be carried out by, or under the immediate direction of, a member of the Institute of Field Archaeologists to ensure that work is carried out to professional standards. Where archaeological work fails to meet the standards set out here, the applicant will be in breach of any archaeological planning condition until matters are rectified. The Planning Authority may refuse to

accept work from, or otherwise take action against, archaeologists who fail to carry out work to these standards.

The Archaeology Unit can comment on tenders submitted in confidence. Tenders should be accompanied by a project design, statement and evidence of competence, including the CV of the Project Director. Before site works start, the proposed arrangements, including a timetable for the work should be agreed with the Highland Council Archaeology Unit in writing.

The brief has been produced specifically for this scheme based on documents supplied at the time it was issued. It is valid for one year from the date of issue.

3) Objectives

- To identify the location, nature and extent of any features or objects of archaeological significance that would be damaged or destroyed by the proposed development.
- Assess the proposed development site in terms of its archaeological and historic environment potential.
- To propose arrangements for the safeguarding where possible, and recording where necessary, of any archaeological features or finds identified.
- To make sure that the needs for archaeological conservation and recording are met without causing any unnecessary delay or disturbance to the development project.

4) Method

a) Desk-based Assessment

A check of all relevant archaeological / historical records, maps and aerial photographs should be undertaken and presented as an Appendix within the report. At least the following sources should be checked:

- *The Highland Council Sites and Monuments Record (SMR)*. Please note - the online SMR 'Am Baile' is not designed for use in development control, for assembling information for forestry or agri-environment schemes, or for constructing management policy of sites. In order to source the full SMR information required for such studies all consultants should approach the Highland Council Archaeology Unit directly.
- *The National Monuments Record of Scotland (NMRS)*
- *Historic Scotland's databases of listed buildings, Scheduled Ancient Monuments and monuments proposed for scheduling.*
- *A List of Scheduled Monuments, Properties in Care and Protected Wrecks in Scotland (Historic Scotland 2002).*

- *The Inventory of Gardens and Designed Landscapes in Scotland (1988).*
- *Relevant Local and Structure Plans.*
- *Vertical stereo aerial photographic coverage held by RCAHMS and the Highland Council Archaeology Unit.*
- *Ordnance Survey map coverage from 1850 onwards, and any other readily available early cartographic sources held at the National Library of Scotland Map Library.*
- *Bibliographic references and early parish accounts.*
- *The Highland Council Archives*
- *any locally held private archives*

b) Geophysical survey

It is important that a geophysical survey of the whole application area is carried out as a first stage, to assist with the identification of the presence / absence, character, extent and condition of sites, monuments and landscape features identified by the desk-based assessment. The survey will also identify any further features of cultural heritage interest not detected from the desk study. 'Archaeological Sites' in this context means individual sites above and below ground; historic buildings or other built structures; designed gardens, cemeteries or landscapes; battlefield or skirmish sites; and sites with historical or cultural associations.

All individual features will be recorded, and mapped on a plan, at a relevant scale, keyed by means of Grid References to the Ordnance Survey mapping.

c) Trial Trenching

Sample areas totalling 10% of the overall application area will be marked off and stripped of topsoil and overburden under the direction of the Archaeological contractor, to ensure controlled conditions. The sample areas will cover the development both spatially and topographically and will aim to expose areas identified by the geophysical survey as being likely to contain archaeological remains. However, it is anticipated that sampling areas may need to vary in shape according to topography and must be informed by the results of the desk-based work. Sample areas should be extended as necessary to reveal the full extent of buried archaeological features.

Trenches should cover the development area spatially and target potential archaeological features and apparently "blank" areas. They should be a mixture of linear and box shaped trenches and should be extended as necessary in order to expose and evaluate archaeological features.

The location of these trenches must be accurately located in three dimensions on the aforementioned site plan.

d) Report

A report must be produced which sets out the results of the work and proposes appropriate arrangements for the safeguarding where possible (or recording where necessary) of any objects or features identified. These arrangements must be agreed by the Highland Council Archaeology Unit.

5) Monitoring

The Archaeological Contractor appointed is responsible for agreeing arrangements for monitoring with Archaeology Unit staff. They will monitor projects as necessary to ensure that minimum standards are met.

Prior notice of fieldwork starting dates, with contact names, telephone numbers and arrangements for access must be given to the Archaeology Unit by the Archaeological Contractor.

Any unexpectedly significant or complex discoveries (or other unexpected occurrences which might significantly affect the archaeological work and /or the development) must be notified immediately by the Archaeological Contractor to the applicant and the Highland Council Archaeology Unit. The finds or features must be left *in situ* until arrangements have been agreed for safeguarding or recording them. In the meantime work may continue on other areas of the site.

6) Reporting

a) Project report

The Archaeological Contractor appointed is responsible for producing a report on the work, and for making sure copies have been received by the recipients listed below. The archaeologist appointed should allow for all costs when estimating for the work. We require archaeologists to submit satisfactory reports within the agreed deadline.

Apart from any copies required by the client, at least **five** copies of the project report must be produced by the archaeologist. These must be submitted to all of the following **within 4 weeks** of the completion of the field work.

- One paper copy for the Council's Area Planning and Building Standards Manager, The Meadows, Dornoch.
- One paper copy to be deposited with the Council's Senior Librarian Information Co-ordinator, Libraries Support Unit, 31a Harbour Road, Inverness IV1 1UA. This will be available for public consultation through the public library service.
- One paper copy to be deposited with the Council's Assistant Curator (Archaeology), Museum & Art Gallery, Castle Wynd, Inverness IV2 3EB.
- Two copies for the Archaeology Unit, Planning and Development Service, Council Offices, Glenurquhart Road, Inverness IV3 5NX :
 - One paper copy

- One copy of the complete report in Adobe Acrobat format (*ie* a pdf file). This can be supplied by email or on a computer disc. Please ensure that all drawings and photographs are included.

The report must include, as a minimum:

- Location plan (bound into the report) showing the project area and archaeological sites and features affected. Grid references must be included.
- Circumstances and objectives of this work, including a copy of this specification
- Scale plans and sections of the trenches excavated.
- Scale plans and photographs of archaeological features identified, plans, sections and photographs of features excavated.
- A full index to any records or other material generated by the project including the archive location.
- An analysis of the project results drawing in comparative data as appropriate, and a statement of the significance of the results as per the Burra Charter.
- General comments and proposals for future archaeological work arising from the carrying out of this project.
- A statement regarding finds and sample collection and retention policies and their justification.
- A set of colour slides illustrating the archaeological features and the project progress.
- A list of finds, set out in the required format for Treasure Trove reporting.
- Weather and other conditions affecting fieldwork.
- Proposals for presenting the results of the work to the local community where appropriate.

b) Presentation

Where significant archaeology has been found, the archaeologist must arrange a presentation of the project results, to the local community within a year of the completion of the fieldwork. This is the responsibility of the Archaeological Contractor, and will not be funded by the Highland Council.

c) DES

A brief summary of the results must be sent to the Council for Scottish Archaeology for inclusion in Discovery and Excavation in Scotland.

d) Copyright

The Highland Council will assume author's copyright unless advised otherwise. However, the Archaeology Unit reserves the right to make the report available for reference and research purposes, either on paper, or electronically. The completed report will be made available for immediate public consultation for research purposes at the Highland Council Sites and Monuments Record (SMR), and through the public library service. The Archaeology Unit will acknowledge copyright in all cases.

7) Finds

Chance finds can be made during any archaeological fieldwork. Archaeologists should note that advice and facilities for emergency conservation and temporary storage can be offered by Inverness Museum. All finds should be notified for Treasure Trove before the report is submitted.

8) Insurance

The Archaeological Contractor appointed must take all necessary measures to conform to the *Health and Safety at Work Acts* and be covered by all necessary insurance. Section 24 of the Highland Council's revised Contracts Standing Orders states:

"All specifications issued by and contracts entered into with the Council in connection with the carrying out of work or the provision of services shall provide that the contractor holds a valid insurance policy, approved by the Council, for:-

- (1) Employers liability - minimum limit - £10m (statutory limit)
- (2) Public liability - minimum limit £5m."

9) General

The Archaeological Contractor agrees by undertaking this work to:

- carry out the work according to the Code of Conduct, standards and guidelines of the Institute of Field Archaeologists.
- agree a timetable for the work with the client and the Highland Council Archaeology Unit.
- not comment to the press or other media without the consent of the applicant and prior notification to the Highland Council Archaeology Unit.
- fully allow for prevailing weather conditions in northern Scotland.

This brief has been produced by the Highland Council Archaeology Unit, to whom any enquiries should be addressed. No one else has authority to vary its terms.